



# **DAVID BRENTON'S TEAM**

---

## **RE/MAX Select, REALTORS**

**48 N Emerson Ave Suite 600 Greenwood, IN 46143-8895**

**(317) 882-7210 Office • (317) 888-7201 Fax**

**[www.move2indy.com](http://www.move2indy.com)**

The covenants provided may or may not include any amendments made due to governing agencies (ie: national, state, city, local and neighborhood agencies). Please contact the Recorder's office for the county where the property is located to receive updated information.

**The information is deemed reliable, but not guaranteed.**

2529

# Heads Addition

Shed by deed that the north plot of Heads Addition is within  
 Indiana's 6th range surveyed by me under a true and correct plat of  
 said quarter Section 22 Township 36 North Range of East described as  
 Beginning at the Southeast corner of the south West quarter of the  
 26th T. 36 N. R. 10 E. 1/4 sec. 26 N. 115.50 feet parallel to the East line of said  
 26th T. 36 N. R. 10 E. 1/4 sec. 26 N. to the  
 3rd section thence S 71.15.50 feet to the place of beginning  
 The dimensions of the lot and those of the streets are marked  
 in feet and decimal parts thereof  
 Witness my hand and signature this 1st day of May 1926

John C. Burt

*[The following text is extremely faint and illegible due to heavy shadowing and poor scan quality. It appears to be a detailed survey description or a list of measurements.]*

Recorded Nov 30, 1926 at 10:10 a.m.

John C. Burt

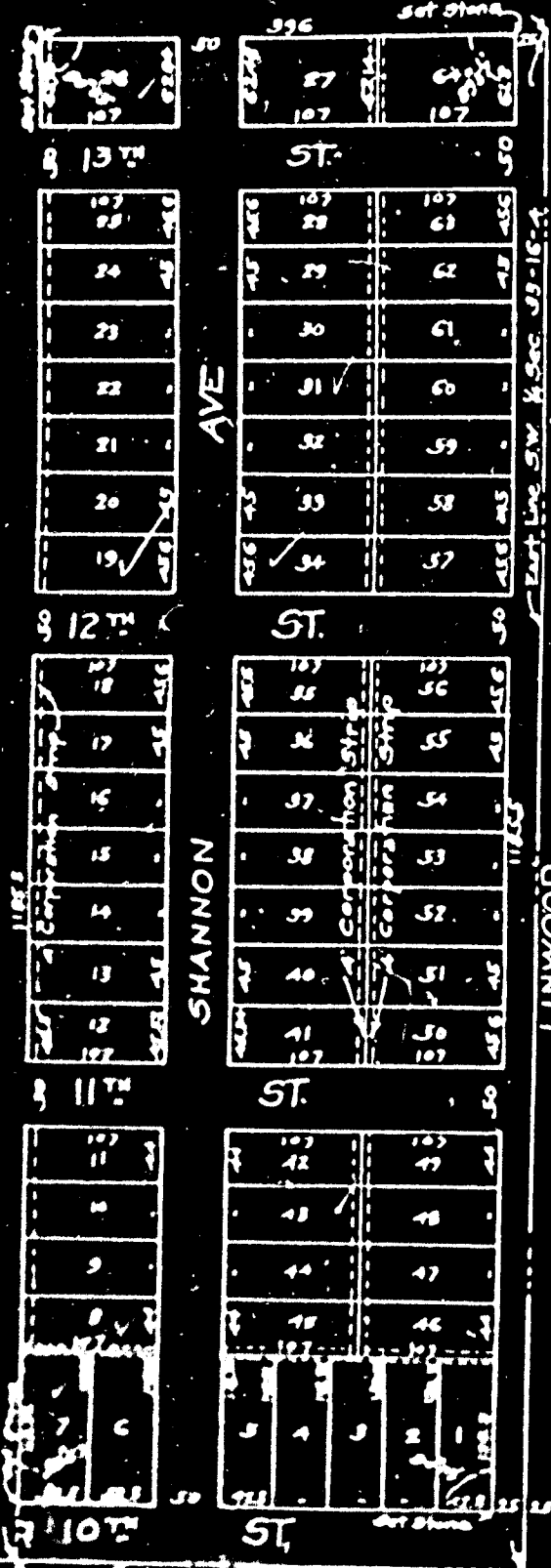

Continuation SW 1/4 Sec 33-16-4